

# KLIKLOK™ Certiwrap C80 Wraparound Cartoner



**BOSCH**  
Invented for life



*Image shows C80 with HMI on optional boom arm*

The popular CERTIWRAP 80 wraparound cartoner is designed to accommodate the sleeving of meal trays, tubs or pots, either individually or in multi-packs, at speeds of up to 80 cartons per minute.

Incorporating an externally mounted, low maintenance drive system, plus Kliklok's reciprocal carton feeder and inclined hopper, the Certiwrap 80 has been developed to handle a range of carton board sleeve profiles to suit the changing packaging requirements of various food sectors.

Thanks to its predominantly stainless steel construction, the Certiwrap 80 is suitable for the wash-down conditions of the dairy and meat processing industries, providing maximum access for routine maintenance and hygiene cleansing.

## Open Design

The open design of the C80 provides high visibility, easy accessibility and superior hygienic construction. Simply lifting the hinged door provides total access for wash down procedure and removal of any debris



## Interactive Colour Touch Screen

A standard feature on the C80, the colour touch screen is simple to learn and operate, using icon-based intuitive controls. It offers superior troubleshooting capability, advanced diagnostics with shift performance data & optional digital manuals. The touch screen also enables accuracy in glue control & application.



## Efficiency & Consistency

This Certiwrap C80 machine offers users a cost effective solution to medium speed cartoning. With the assistance of full carton and product control throughout the machine, this compact machine offers consistently square cartons. Additional carton design features are also available including: Gusset/ Advertising panels, kick in corners to secure containers within cartons and hot melt or lock carton closure.

**Pioneering  
Engineering**

### Performance

#### Speed:

Up to 80 cartons per minute depending on size & style of carton & product.

### Carton Size Range (mm)

Machine Pitch	12"	
	Max	Min
Length	270	63
Width	500	203

### Product Size Range (mm)

Machine Pitch	12"	
	Max	Min
Length	270	63
Width	254	38
Depth	127	19

### Operating Requirements

#### ELECTRICAL:

400V 3 Phase 50HZ plus neutral & earth  
Electrical system conforms to HSWA/IEC 201 (EN60204-1)

**POWER:** Maximum power 6.5kW

#### AIR CONSUMPTION:

10ltrs/min (0.35 SCFM) @ 4 bar (60 psig)

### Construction

Stainless steel frame. All shafts are metric and manufactured of stainless steel. Chains and sprockets of ANSI standards and are nickel plated.

Clear polycarbonate overhead guards. Other fabricated components are generally stainless steel or composite materials.  
Approximate shipping weight: 2000kgs

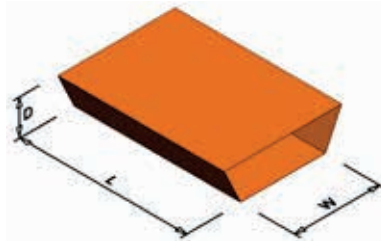

### Standard Features

- Stainless steel frame
- Reciprocating carton feeder
- Gated 'flag' infeed
- 1.8m (4 ft) conveyor
- Colour touch screen control
- Nordson hot melt glue jetting system
- Quick size change
- Status beacon
- IP55
- CE Mark

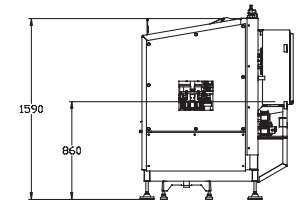
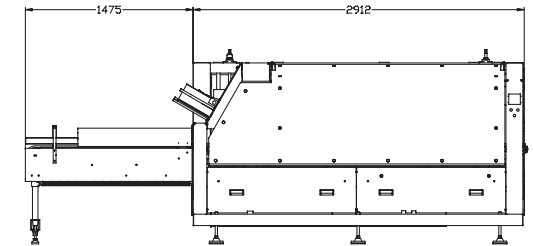
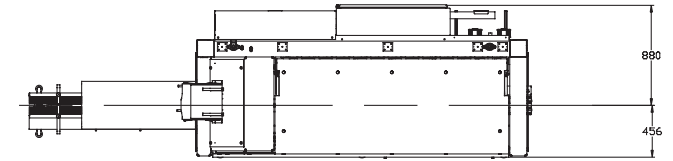

### Optional Features

- Wash Down Sanitation Specifications
- Lock Closure